



Ayrstone AyrMesh™
Router Setup

Quickstart Guide
Ayrstone.com



www.Ayrstone.com
888-837-0637

1

1 Start Here

Quickstart Guide- AyrMesh™ Router

Visit Ayrstone.com/support
for detailed instructions,
videos, slide shows, and a
troubleshooting guide.



scan with mobile device
www.Ayrstone.com/support

Check the contents of the box:

- Router
- Antenna
- Ethernet Cable
- Power Supply



2

Gather What You'll Need

- Router and Included Parts
- An Additional Ethernet Cable
- Computer with an Ethernet Port
- Always on Internet Connection

DSL, Cable, Satellite, etc. (not dial-up)

You may also want:

- One or more AyrMesh Hubs
- Additional Ethernet Cables

3

Assemble Router and Antenna

- Screw Antenna finger-tight (pic.3)
- onto the Antenna Connector on the back of the Router. (pic.2)
- Do Not Use Tools.

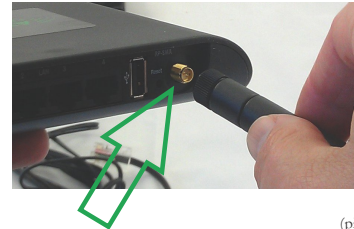

(pic.2)



(pic.3)

4

Connect Computer to Router

- Plug one end of an Ethernet Cable into one of the 4 LAN ports on the back of the Router. (pic.4)
- Plug the other end of the Ethernet Cable into the ethernet port on your computer. (pic.5)

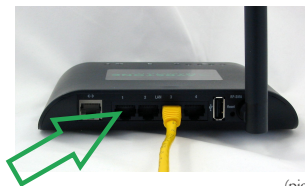

(pic.4)



(pic.5)

5

Connect Router to Power Supply

- Plug one end of an Ethernet Cable into the WAN port on the back of the Router. (pic.6)
- Plug the other end of the Ethernet Cable into the plug on the Power Supply. (pic.7)
- Plug Power Supply into wall. (pic.8)

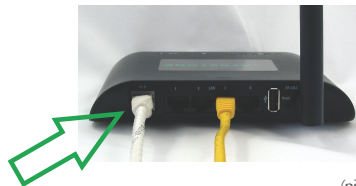

(pic.6)

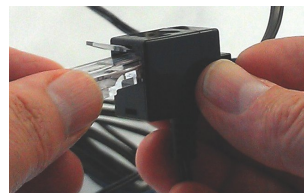

(pic.7)



(pic.8)

6

Login To Aymesh Router

- Start an Internet Browser
Internet Explorer, Firefox, Safari, Chrome, etc.
- On the URL Line type: 10.0.0.1
- Press: **Enter** on your keyboard
- Login Page will show on screen. (pic.9)
- Enter Username: **ayrmesh**
- Enter Password: **ayrmesh**
- Press: **Login** or **Enter** on your keyboard

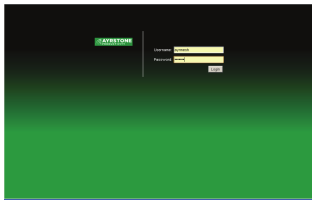

(pic.9)

If the Login page does not appear on your screen, follow the Ayrmesh Router Troubleshooting Guide.

7

Set Up Internet Connection

- Router page will show on screen. (pic.10)
- Press: [Click HERE to set up your router.](#)

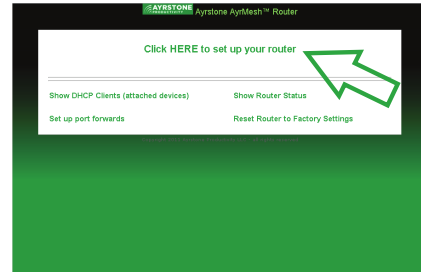

(pic.10)

- Setup Internet Connection page will show on screen. (pic.11)
- Select: Your Internet Connection
DHCP, PPPoE or Static

7

Continued

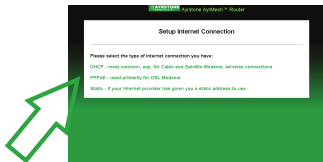

(pic.11)

- Follow instructions for your internet connection.

DHCP



(pic.12)

- Click Next. (pic.12)
- WiFi Access page will appear on screen. Go to step 8.

PPPoE



(pic.13)

7

Continued

- Enter PPP User Name and Password. (pic.13)
Provided by Internet Provider.
- Does your ISP require encryption? (pic.13)
No: Do Not check encryption box.
Yes: Check encryption box. (This is rare)
- Click Next. (pic.13)
- WiFi Access page will appear on screen. Go to step 8.

STATIC

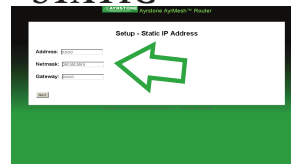

(pic.14)

- Enter IP address, netmask and gateway IP address. (pic.14)
Provided by Internet Provider.
- Click Next. (pic.14)
- WiFi Access page will appear on screen. Go to step 8.

8

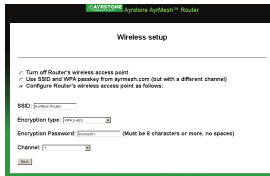
Set Up
WiFi Access Point

Choose: One of three options.

1.) If your AyrMesh hub provides good Wifi through - out your house.

- **Select: Turn off Router's wireless access point**
- Click Next.
- Go to Step 9.

2.) If you do not have an AyrMesh Hub, or If your AyrMesh Hub is not usable throughout your house. (e.g. Hub is above a metal roof)

- **Select: Use SSID and WPA passkey from aymesh.com**
- Click Next.
- Go to Step 9.

8

Continued

3.) If you want a separate WiFi signal from your Router, and if your AyrMesh hub provides good Wifi throughout your house.

• **Select: Configure Router's wireless access point as follows:**

- Fill in SSID
(Name of the network. Different from your AyrMesh SSID.)
- Select Encryption type.
Select WPA2-AES if supported by all devices.
Select WPA-TKIP if you have older devices.
- Fill in Encryption Password.
Ensure you can remember it and keep it a secret.
- Fill in the Channel.
Use a channel that is at least 5 away from your Hub's channel. e.g. Hub is on channel 6, Router can be set to channel 1 (default).
- Click Next.
- Go to Step 9.

9

Final Steps

- Router will reboot.
Takes about one minute.
 - Login Page will show on screen. (pic.9)
If you get a timeout message click the browser's refresh button.
 - Connect: Short Ethernet cable attached to the Power Supply to your Internet connection device. (pic.15)
Modem, Radio or Primary Router
 - Test Internet connection.
Connection is Good: Go to Step 10
Unable to Connect:
See the Ayrmesh Router Troubleshooting Guide.
- Connecting to an "all-in-one" router/gateway device?
Put AyrMesh into the DMZ of the device:
Visit <http://ayrstone.com/support> for examples.
Contact your ISP for detailed instructions.



(pic.15)

10

Login to
Ayrmesh.com

- Start an Internet Browser
Internet Explorer, Firefox, Safari, Chrome, etc.
- On the URL Line type: Ayrmesh.com
- If you have an Ayrmesh account:
Log In.
- If you do not have an Ayrmesh account:

Click: *No username? Sign up now-it's free* (pic.15)

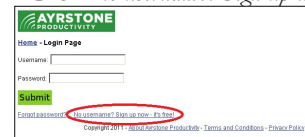

(pic.15)

- Fill in the Sign up Page
(Be sure to supply a working email address.)

On Ayrmesh.com, you can monitor and control your Ayrmesh network.

Note: Once you set up your router it will appear on your front page.



Ayrstone AyrMesh
Router Setup

Troubleshooting Guide
Ayrstone.com



www.Ayrstone.com
888-837-0637

1

1 Start Here

Troubleshooting Guide-

AyrMesh Router

Visit Ayrstone.com/support
for detailed instructions,
videos, slide shows, and a
troubleshooting guide.



scan with mobile device
www.Ayrstone.com/support

2

2 Identify Problem

- Login Page did not show on screen.
Go to Step 3.
- Unable to connect to Internet.
Go to Step 4.
- Problem not listed above.
Go to Step 5.

3

Troubleshoot

Login Page did not show on screen

Ensure:

- Router is powered on, and lights are on.
 - Make sure Power Supply is connected to Router with a separate Ethernet cable (pic.2 & 3), not the short cable attached to the Power Supply. (pic.1)
 - Cables are clicked in on both ends.
 - Computer is plugged into a LAN port, not the WAN port. (LAN light should be lit)
 - Computer gets IP address automatically.
- Follow steps on right.

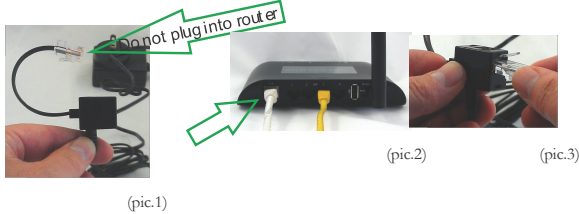

If the above steps did not resolve your issue Go To Step 5.

3

continued

Ensure computer is configured properly:

Mac:

Open *System Preferences*.

Select *Network*.

Select *Ethernet*.

Ensure *Using DHCP* is selected.

Windows: 7 and Vista

Open your *Control Panel*.

Select *Networking* or *Network and Sharing Center*.

Select *Change Adapter Setting*.

Right-Click *Local Area Connection*.

Select *Properties*.

Select *TCP/IP* or *Internet Protocol Version 4*

Select *Properties*

Ensure *Obtain an IP address automatically* is checked.

4

Troubleshoot

Unable to Connect to Internet

Ensure:

- Internet access device is powered on.
- Internet access device is connected to the WAN port.
- Reboot the Internet access device.
- Reconfigure Router connection settings.
- Connecting to an “all-in-one” router/gateway device?

Put AyrMesh into the DMZ of the device:

Visit <http://ayrstone.com/support> for examples.
Contact your ISP for detailed instructions.

If the above steps did not resolve your issue Go To Step 5.

5

Contact Us

Additional Help

Visit Ayrstone.com/support

for detailed instructions, videos, slide shows, and a troubleshooting guide.



scan with mobile device
www.Ayrstone.com/support

Email: support@ayrstone.com

Phone: 1-888-837-0637 x101